

LOCATION PLAN  
SCALE 1 : 20000

OPTION A



LOCATION PLAN  
SCALE 1 : 20000

OPTION B

- LEGEND:**
- PRELIMINARY PROJECT BOUNDARY
  - EXISTING TREE TO BE RETAINED
  - EXISTING TREE TO BE TRANSPLANTED
  - EXISTING TREE TO BE FELLED
  - DEAD TREE TO BE REMOVED
  - TREE TRUNK DIAMETER GREATER THAN 500MM

Client  
**HIGHWAYS DEPARTMENT WORKS DIVISION**

Consultants  
**Mannings (Asia) Consultants Ltd**  
*in association with*  
**BMT Asia Pacific**

ADILIMITED  
LANDSCAPE ARCHITECTURE, URBAN DESIGN AND MASTER PLANNING  
10/F BANGKOK BANK BUILDING, 16 EDWARDS STREET WEST HONG KONG  
TEL: (852) 2100 8888 FAX: (852) 2100 8889  
www.mannings.com.hk www.bmt.com.hk

Project  
Agreement No. WD 7/2007  
Upgrading of Remaining Sections  
of Kam Tin Road & Lam Kam Road  
Environmental Impact Assessment

Title  
**EXPLORATION OF ALTERNATIVE SCHEMES**

Drawing No.  
Figure 9.15A

Revision  
B



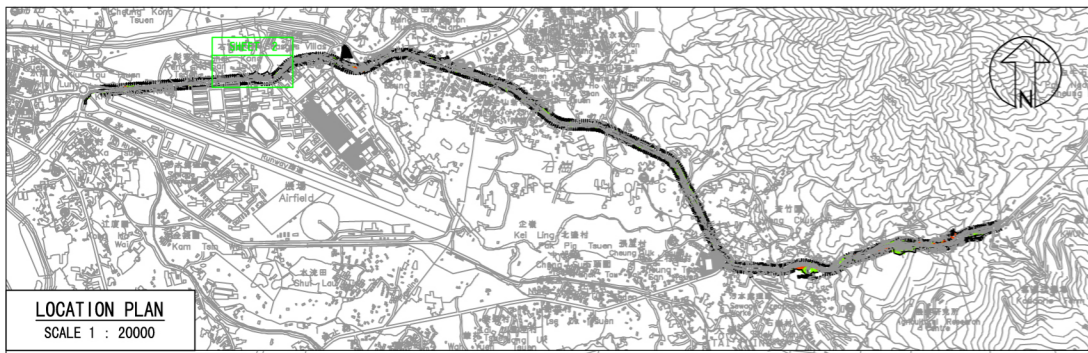

LOCATION PLAN  
SCALE 1 : 20000

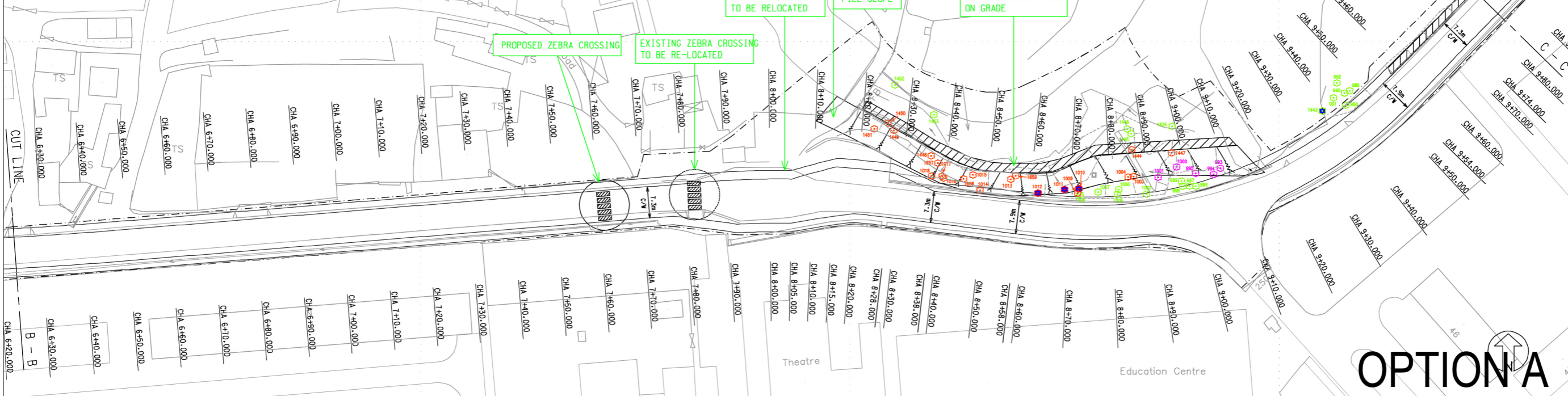

# OPTION A

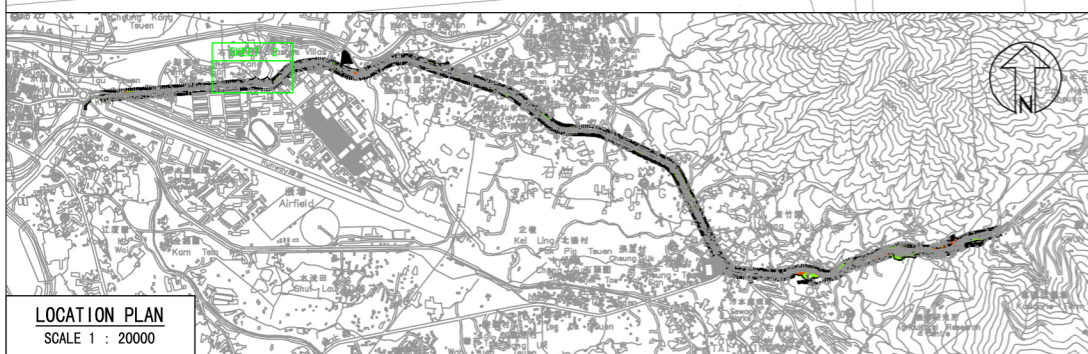

LOCATION PLAN  
SCALE 1 : 20000

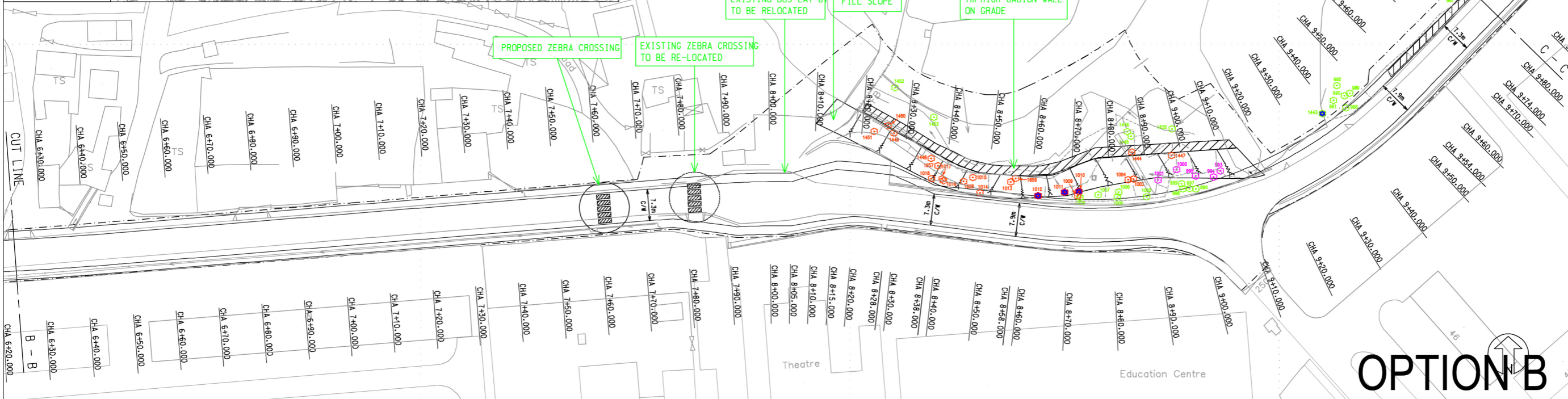

# OPTION B

- LEGEND:**
- PRELIMINARY PROJECT BOUNDARY
  - EXISTING TREE TO BE RETAINED
  - EXISTING TREE TO BE TRANSPLANTED
  - EXISTING TREE TO BE FELLED
  - DEAD TREE TO BE REMOVED
  - TREE TRUNK DIAMETER GREATER THAN 500MM

Client: **HIGHWAYS DEPARTMENT WORKS DIVISION**

Consultants: **Mannings (Asia) Consultants Ltd**  
in association with **BMT Asia Pacific**

ADILIMITED  
LANDSCAPE ARCHITECTURE, URBAN DESIGN AND MASTER PLANNING  
10/F BANGKOK BANK BUILDING, 10 BROADWAY STRAND WEST HONGKONG  
TEL: (852) 2211 8888 FAX: (852) 2211 8889  
www.mannings.com.hk www.bmt.com.hk

Project Agreement No. WD 7/2007  
Upgrading of Remaining Sections of Kam Tin Road & Lam Kam Road Environmental Impact Assessment

Title: **EXPLORATION OF ALTERNATIVE SCHEMES**

Drawing No. **Figure 9.15C** Revision **B**

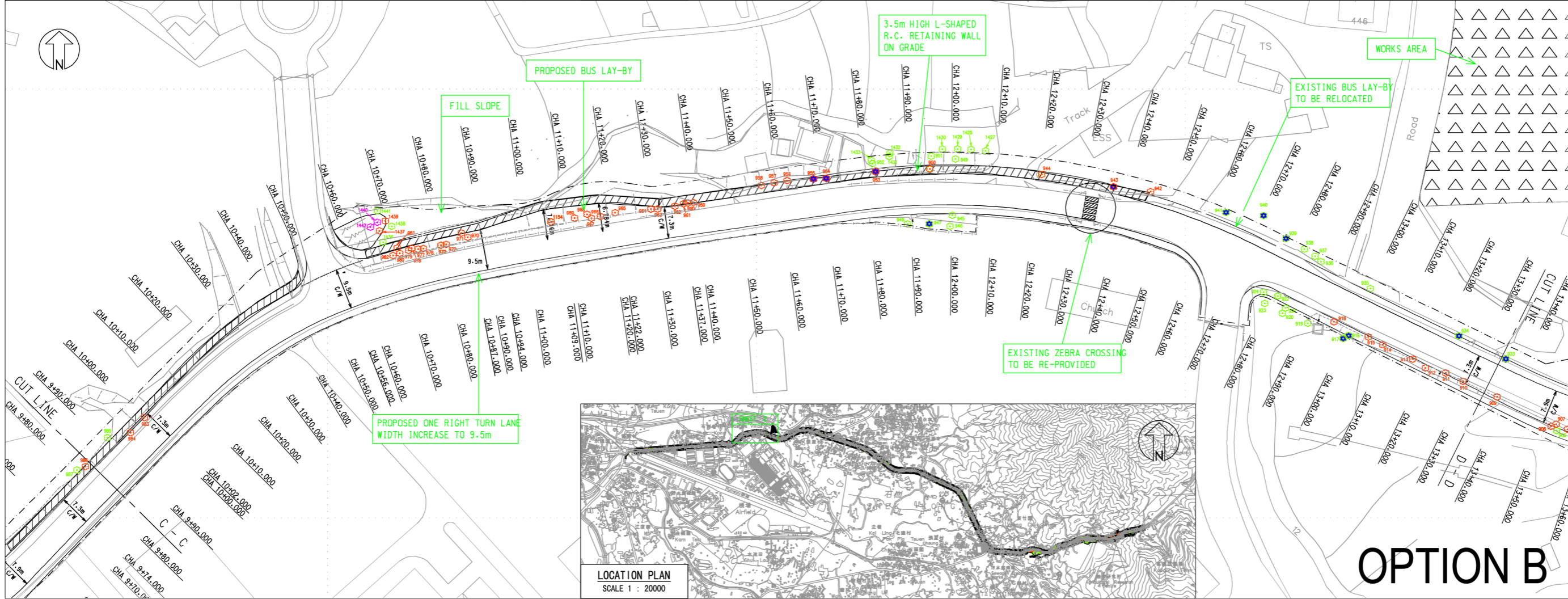
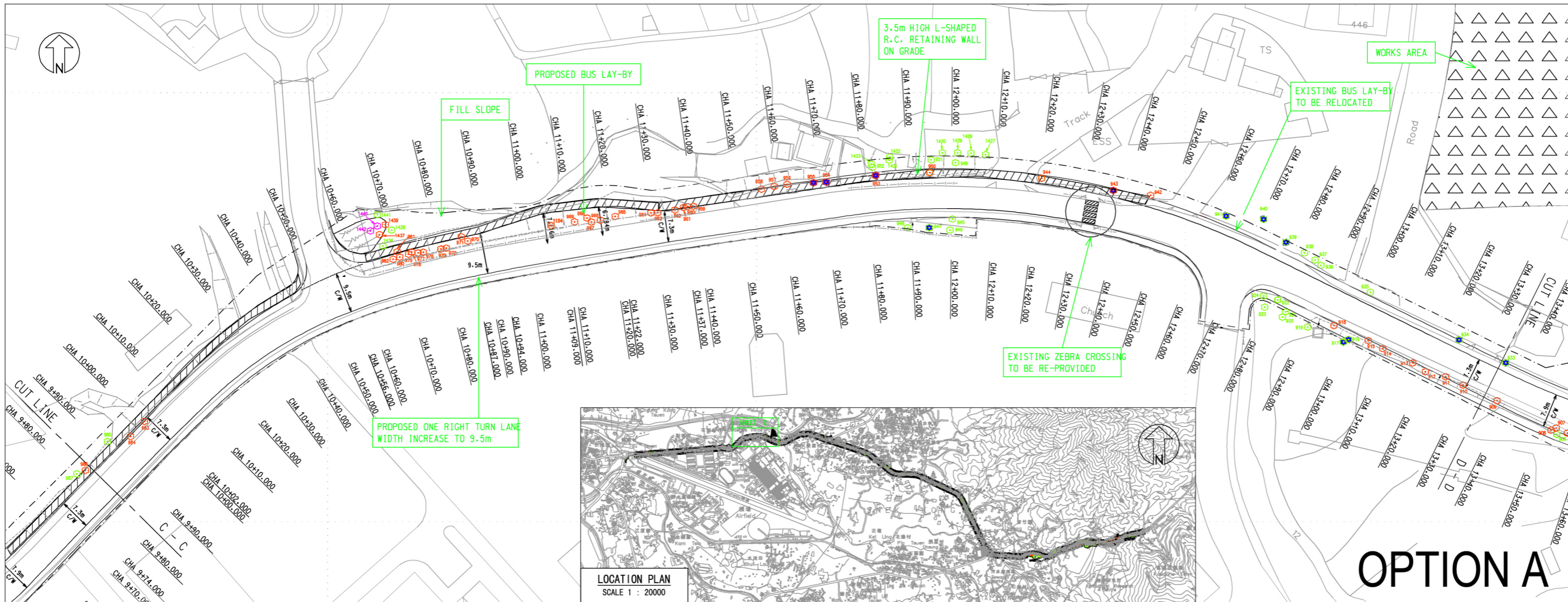

- LEGEND:**
- PRELIMINARY PROJECT BOUNDARY
  - 🌳 EXISTING TREE TO BE RETAINED
  - 🌳 EXISTING TREE TO BE TRANSPLANTED
  - 🌳 EXISTING TREE TO BE FELLED
  - 🌳 DEAD TREE TO BE REMOVED
  - 🌳 TREE TRUNK DIAMETER GREATER THAN 500MM

Client: **HIGHWAYS DEPARTMENT WORKS DIVISION**

Consultants: **Mannings (Asia) Consultants Ltd in association with BMT Asia Pacific**

ADP LIMITED LANDSCAPE ARCHITECTURE, URBAN DESIGN AND MASTER PLANNING  
 10/F BANGKOK BANK BUILDING, 10 BROADWAY STRAND WEST HONGKONG  
 電話: (852) 2211 2211 傳真: (852) 2211 2211  
 香港: (852) 2211 2211 中國: (852) 2211 2211

Project Agreement No. WD 7/2007  
 Upgrading of Remaining Sections of Kam Tin Road & Lam Kam Road  
 Environmental Impact Assessment

**EXPLORATION OF ALTERNATIVE SCHEMES**

Drawing No. **Figure 9.15D** Revison **B**

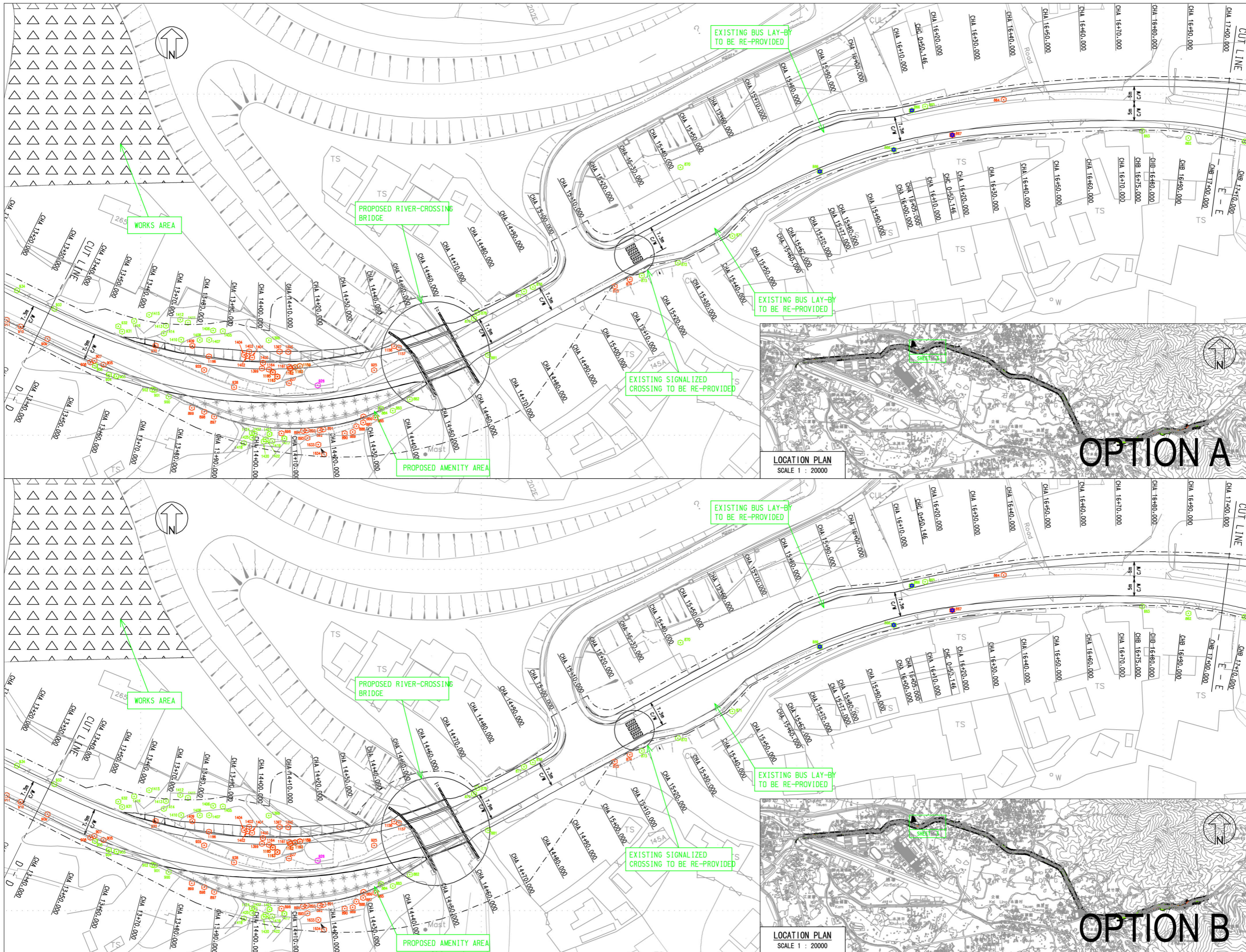

- LEGEND:**
- PRELIMINARY PROJECT BOUNDARY
  - EXISTING TREE TO BE RETAINED
  - EXISTING TREE TO BE TRANSPLANTED
  - EXISTING TREE TO BE FELLED
  - DEAD TREE TO BE REMOVED
  - TREE TRUNK DIAMETER GREATER THAN 500MM

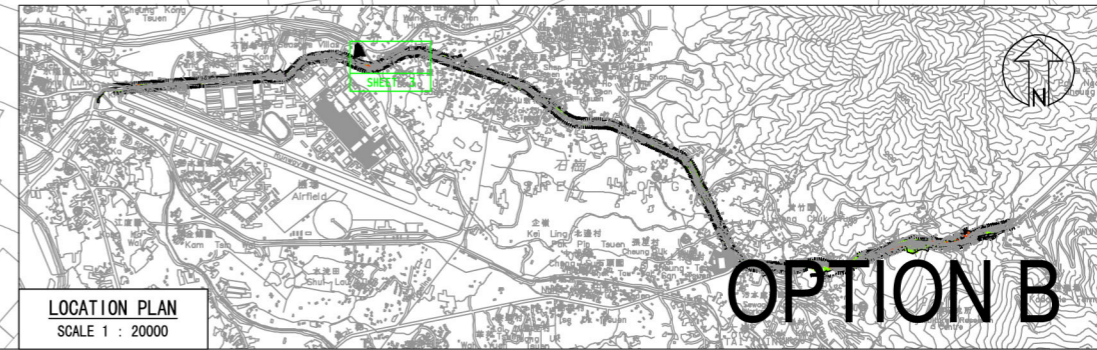
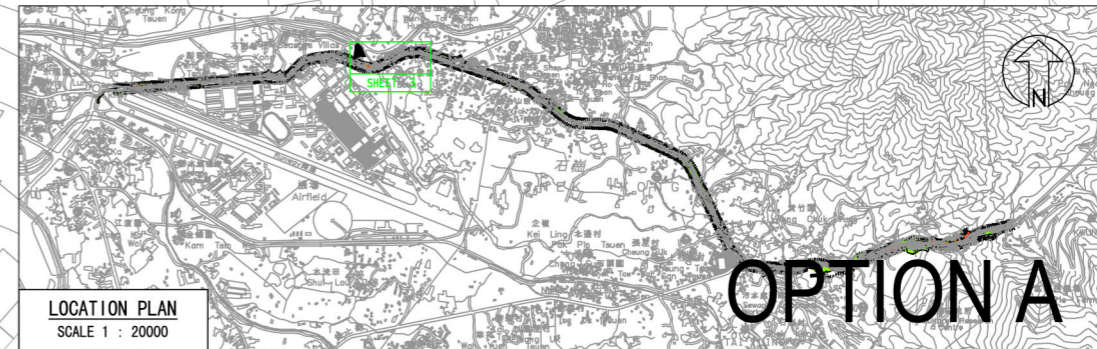

Client  
**HIGHWAYS DEPARTMENT WORKS DIVISION**

Consultants  
**Mannings (Asia) Consultants Ltd**  
in association with  
**BMT Asia Pacific**

ADP  
ADP LIMITED  
LANDSCAPE ARCHITECTURE, URBAN DESIGN AND MASTER PLANNING  
10/F BANCROFT BANK BUILDING, 10 BROADWAY STRAND WEST HONGKONG  
TEL: (852) 2532 2111 FAX: (852) 2532 2112  
www.adp.com.hk

Project  
Agreement No. WD 7/2007  
Upgrading of Remaining Sections  
of Kam Tin Road & Lam Kam Road  
Environmental Impact Assessment

Title  
**EXPLORATION OF ALTERNATIVE SCHEMES**

Drawing No. Figure 9.15E  
Revision B

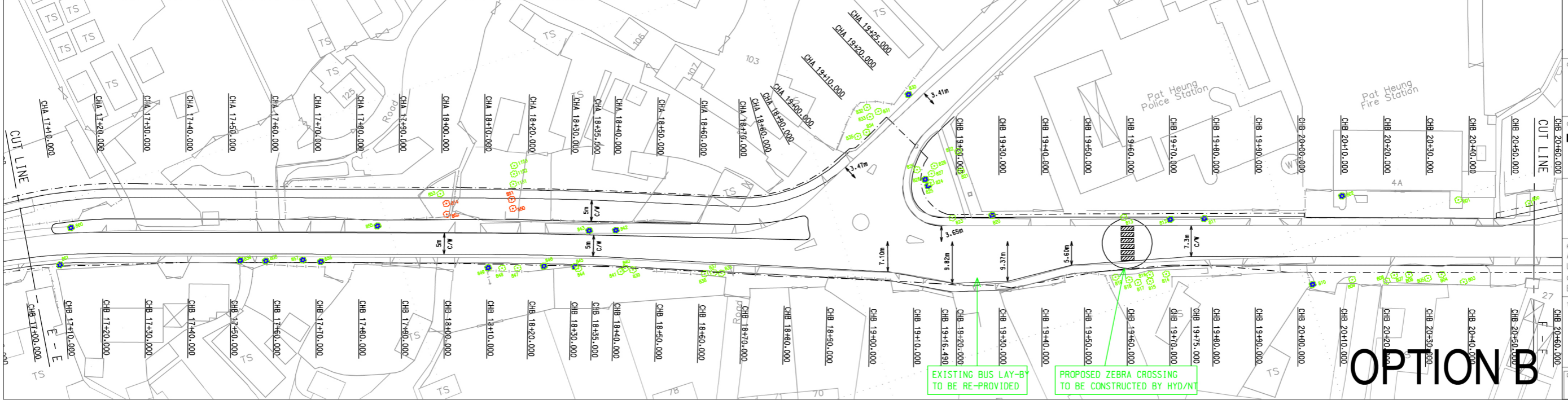
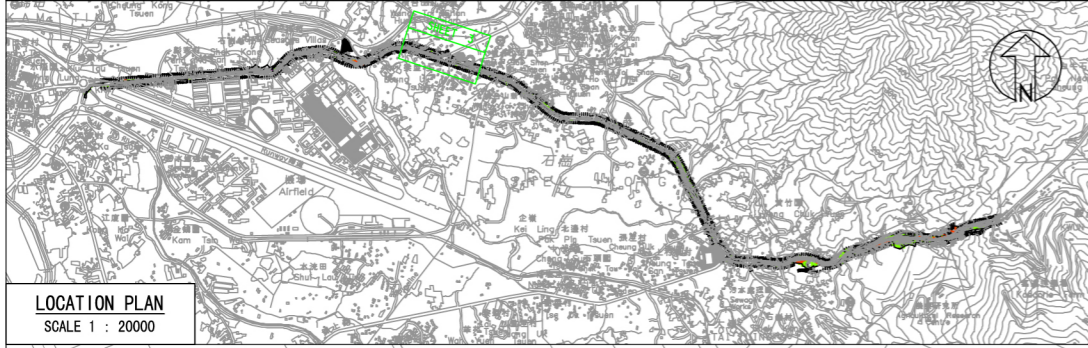
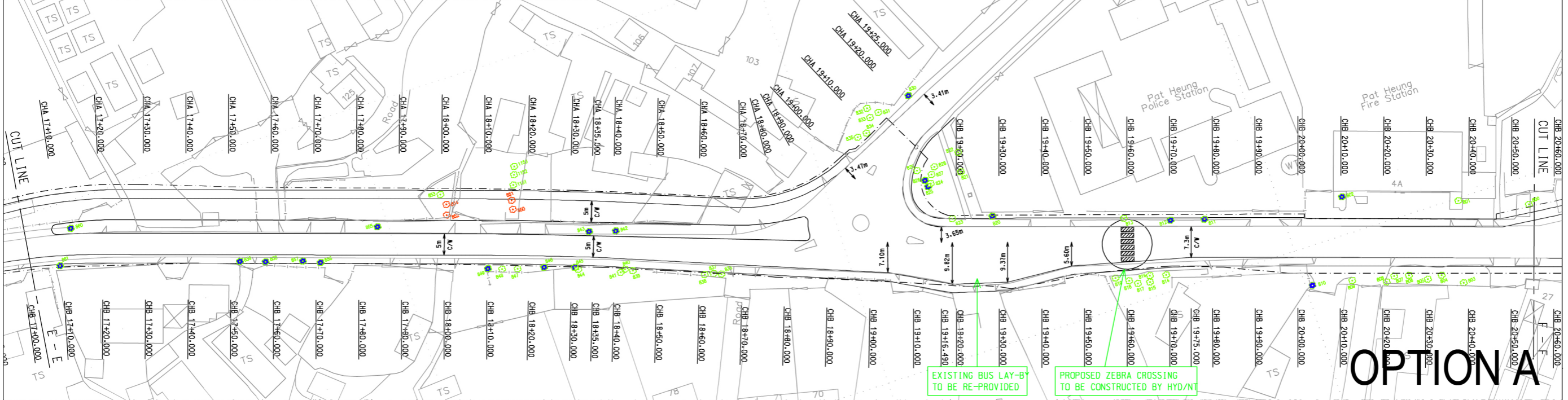
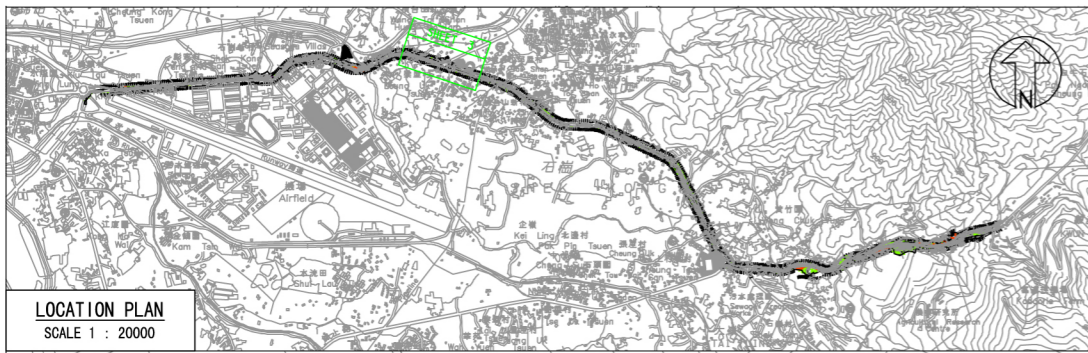

- LEGEND:**
- PRELIMINARY PROJECT BOUNDARY
  - EXISTING TREE TO BE RETAINED
  - EXISTING TREE TO BE TRANSPLANTED
  - EXISTING TREE TO BE FELLED
  - DEAD TREE TO BE REMOVED
  - TREE TRUNK DIAMETER GREATER THAN 500MM

Client  
**HIGHWAYS DEPARTMENT WORKS DIVISION**

Consultants  
**Mannings (Asia) Consultants Ltd**  
in association with  
**BMT Asia Pacific**

ADILIMITED  
LANDSCAPE ARCHITECTURE, URBAN DESIGN AND MASTER PLANNING  
107 BANGKOK BANK BUILDING, 16 SCOVILLE STRAND WEST HONG KONG  
TEL: (852) 2188 8888 FAX: (852) 2188 8888  
www.mannings.com.hk www.bmt.com.hk

Project Agreement No. WD 7/2007  
Upgrading of Remaining Sections of Kam Tin Road & Lam Kam Road  
Environmental Impact Assessment

Title  
**EXPLORATION OF ALTERNATIVE SCHEMES**

Drawing No. **Figure 9.15F** Revision **B**

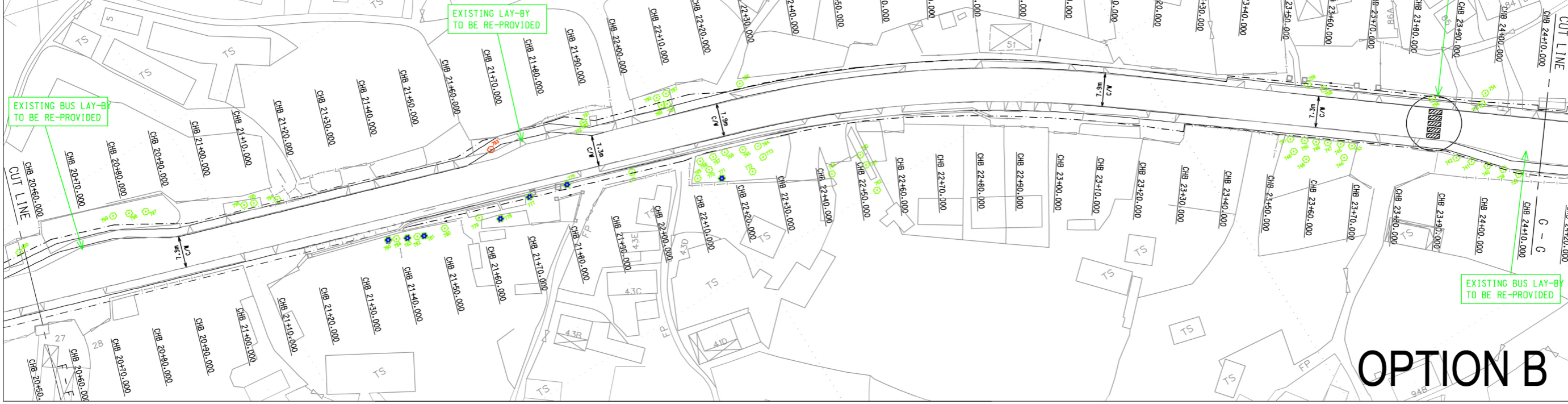
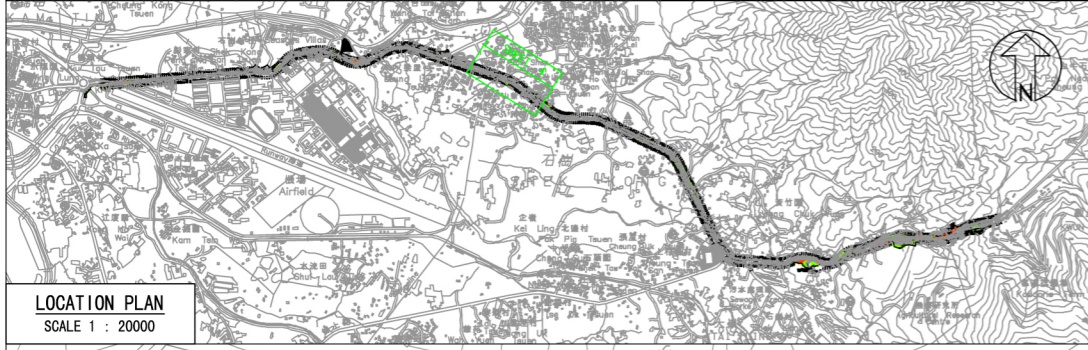

- LEGEND:**
- PRELIMINARY PROJECT BOUNDARY
  - EXISTING TREE TO BE RETAINED
  - EXISTING TREE TO BE TRANSPLANTED
  - EXISTING TREE TO BE FELLED
  - DEAD TREE TO BE REMOVED
  - TREE TRUNK DIAMETER GREATER THAN 500MM

Client  
**HIGHWAYS DEPARTMENT WORKS DIVISION**

Consultants  
**Mannings (Asia) Consultants Ltd**  
in association with  
**BMT Asia Pacific**

ADILIMITED  
LANDSCAPE ARCHITECTURE, URBAN DESIGN AND MASTER PLANNING  
10/F BANCROFT WARE BUILDING, 10 BANCROFT STREET WEST HONGKONG  
TEL: (852) 2518 2222 FAX: (852) 2518 2220  
www.mannings.com.hk www.bmt.com.hk

ADI

Project Agreement No. WD 7/2007  
Upgrading of Remaining Sections of Kam Tin Road & Lam Kam Road Environmental Impact Assessment

Title  
**EXPLORATION OF ALTERNATIVE SCHEMES**

Drawing No. Figure 9.15G  
Revision B



**OPTION A**

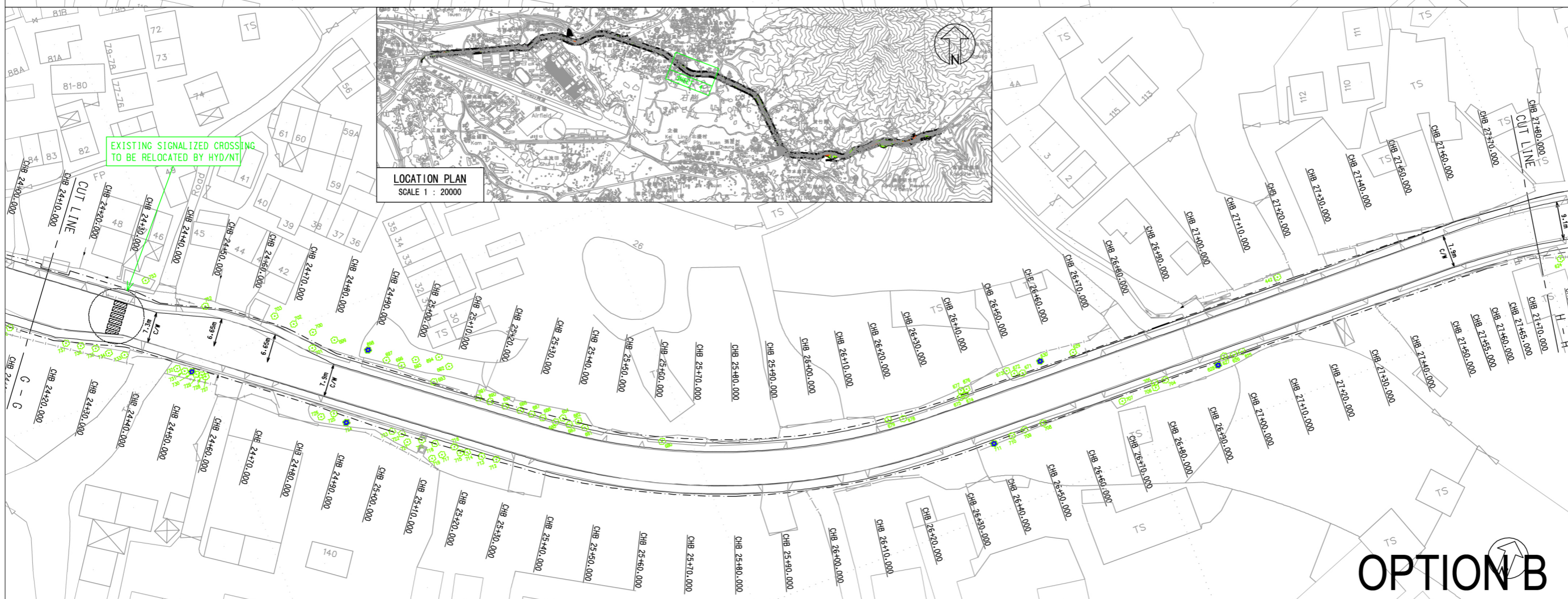

**OPTION B**

- LEGEND:**
- PRELIMINARY PROJECT BOUNDARY
  - EXISTING TREE TO BE RETAINED
  - EXISTING TREE TO BE TRANSPLANTED
  - EXISTING TREE TO BE FELLED
  - DEAD TREE TO BE REMOVED
  - TREE TRUNK DIAMETER GREATER THAN 500MM

Client  
**HIGHWAYS DEPARTMENT WORKS DIVISION**

Consultants  
**Mannings (Asia) Consultants Ltd**  
*in association with*  
**BMT Asia Pacific**

ADILIMITED  
 LANDSCAPE ARCHITECTURE, URBAN DESIGN AND MASTER PLANNING  
 10/F BANGKOK BANK BUILDING, 10 SCOVILLE STREET WEST HONG KONG  
 電話: (852) 2511 2211 傳真: (852) 2511 2212  
 香港中環皇后大道中10號10樓

Project  
 Agreement No. WD 7/2007  
 Upgrading of Remaining Sections  
 of Kam Tin Road & Lam Kam Road  
 Environmental Impact Assessment

Title  
**EXPLORATION OF ALTERNATIVE SCHEMES**

Drawing No.  
 Figure 9.15H

Revision  
 B



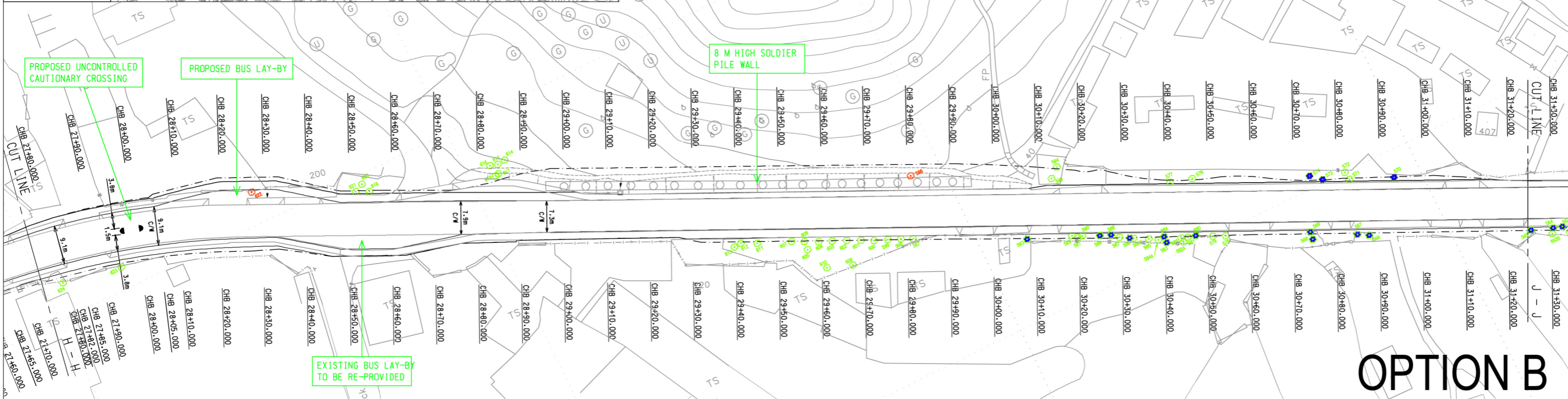
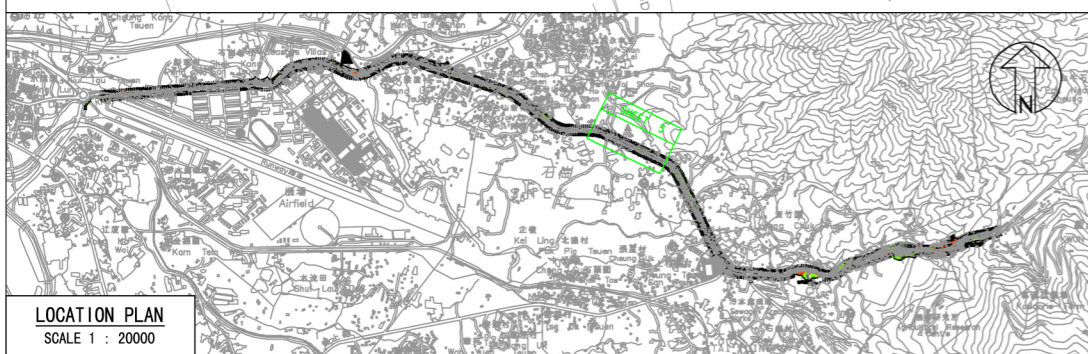
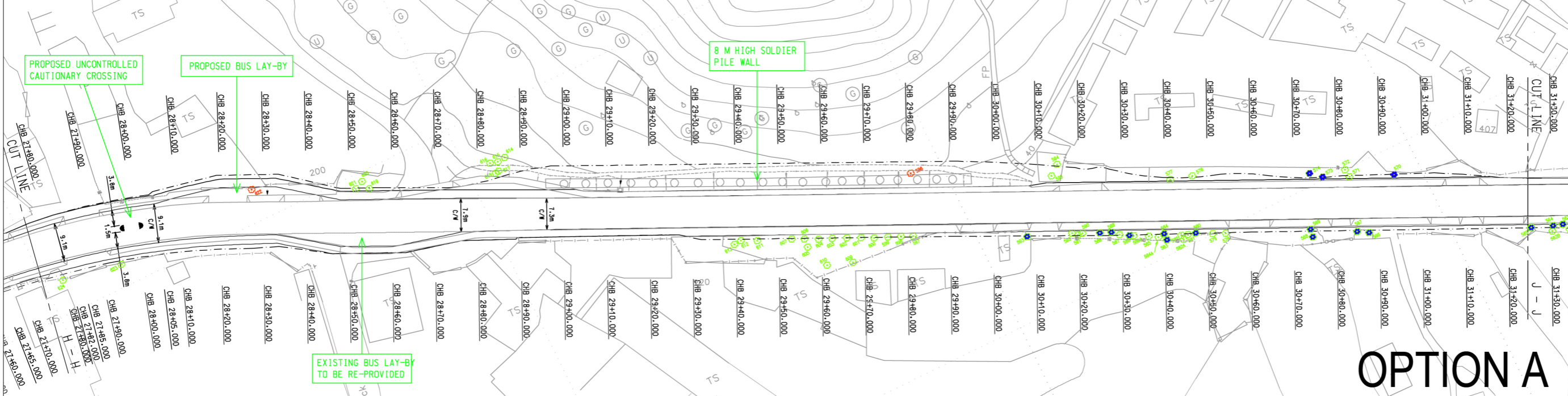

- LEGEND:**
- PRELIMINARY PROJECT BOUNDARY
  - EXISTING TREE TO BE RETAINED
  - EXISTING TREE TO BE TRANSPLANTED
  - EXISTING TREE TO BE FELLED
  - DEAD TREE TO BE REMOVED
  - TREE TRUNK DIAMETER GREATER THAN 500MM

Client  
**HIGHWAYS DEPARTMENT WORKS DIVISION**

Consultants  
**Mannings (Asia) Consultants Ltd**  
in association with  
**BMT Asia Pacific**

ADILIMITED  
LANDSCAPE ARCHITECTURE, URBAN DESIGN AND MASTER PLANNING  
107 BANGKOK BANK BUILDING, 10 BROADWAY STRAND WEST HONGKONG  
TEL: (852) 2188 2211 FAX: (852) 2188 2210  
www.adilimited.com.hk  
ADILIMITED 有限公司  
香港中環皇后大道西107號香港銀行大廈10樓  
電話：(852) 2188 2211 傳真：(852) 2188 2210

Project Agreement No. WD 7/2007  
Upgrading of Remaining Sections of Kam Tin Road & Lam Kam Road Environmental Impact Assessment

Title  
**EXPLORATION OF ALTERNATIVE SCHEMES**

Drawing No. Figure 9.15i  
Revision B

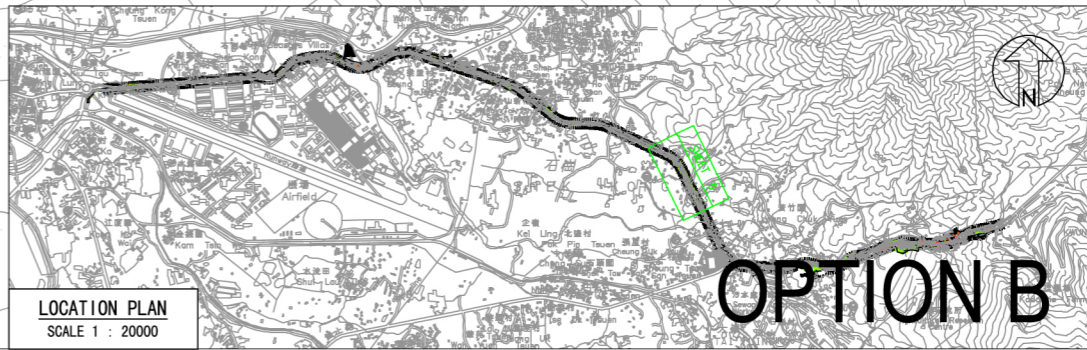
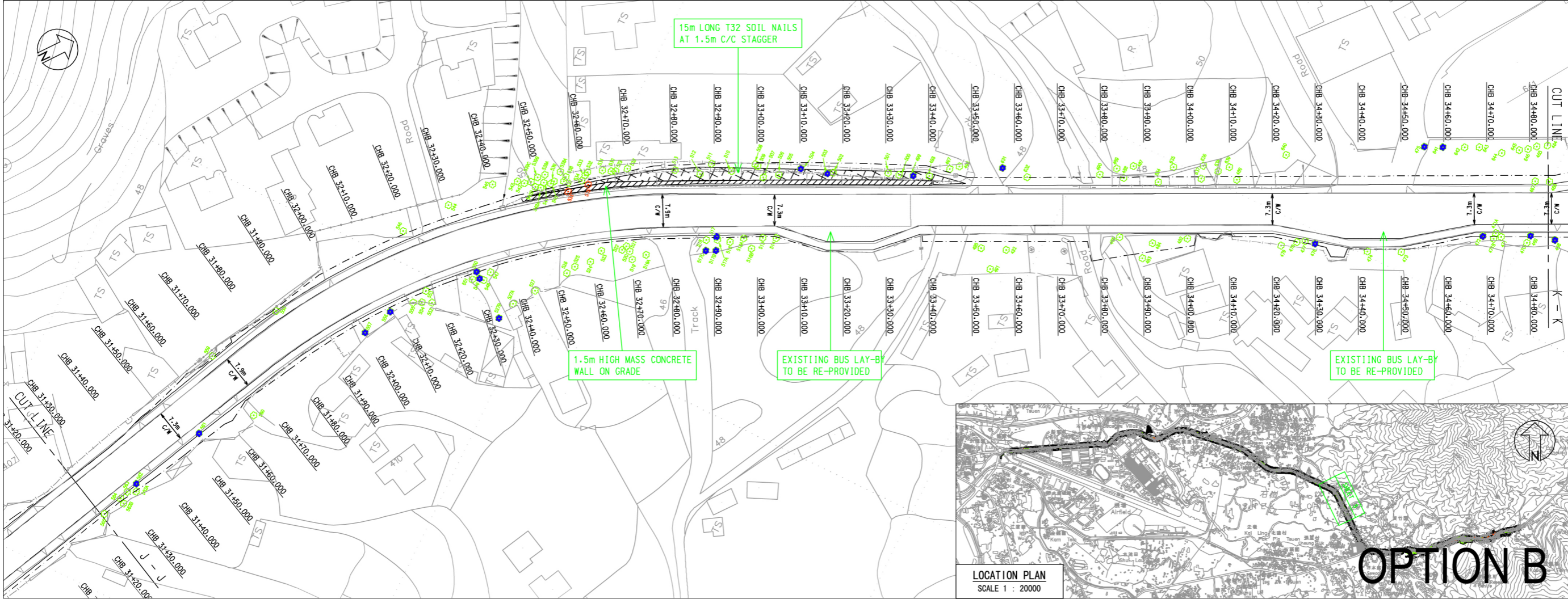
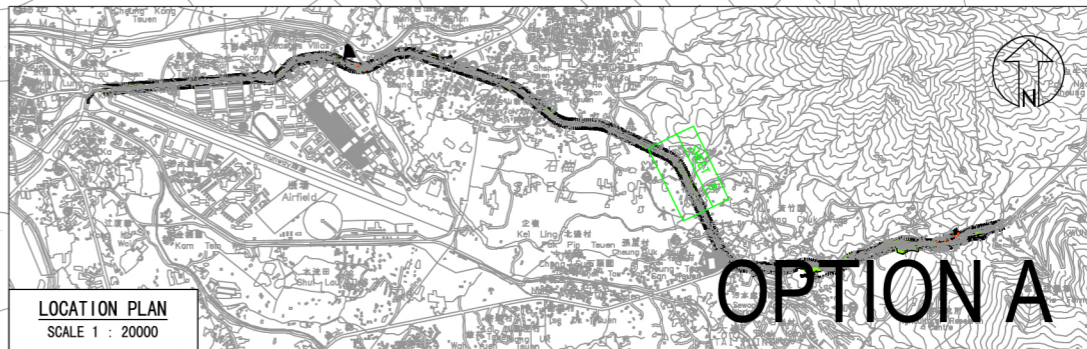
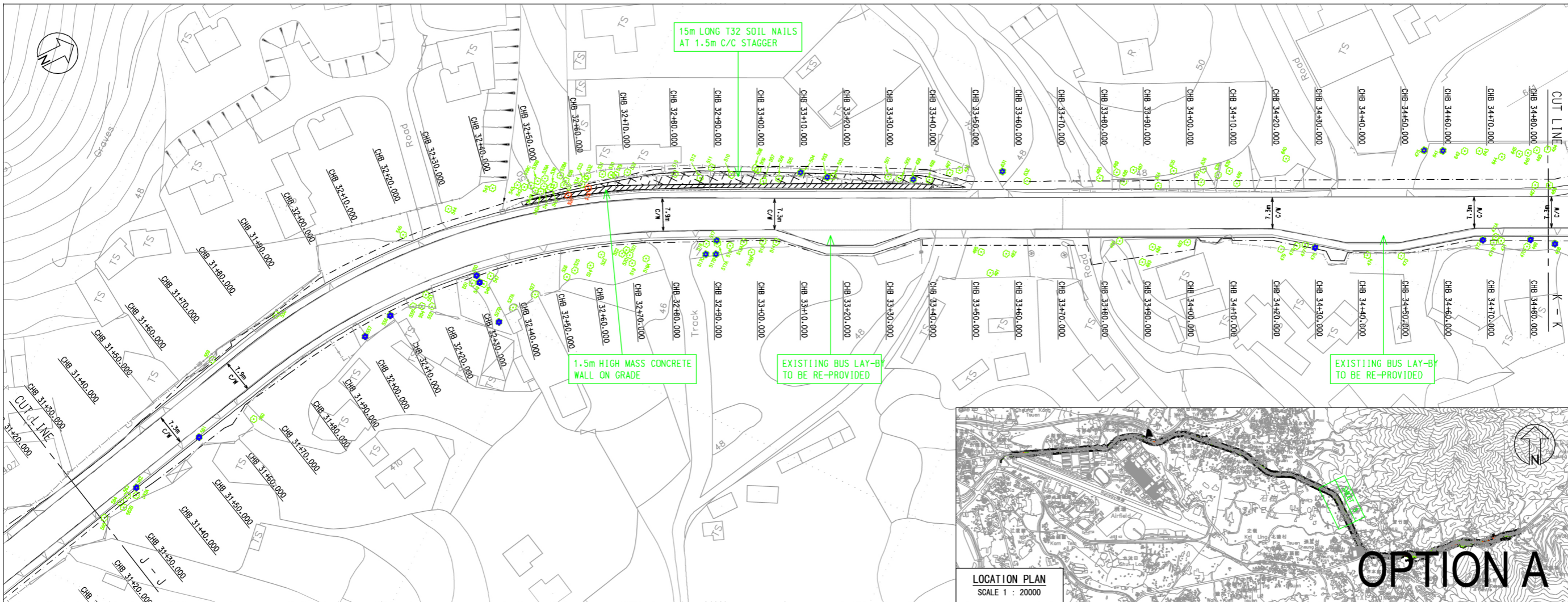

- LEGEND:**
- PRELIMINARY PROJECT BOUNDARY
  - EXISTING TREE TO BE RETAINED
  - EXISTING TREE TO BE TRANSPLANTED
  - EXISTING TREE TO BE FELLED
  - DEAD TREE TO BE REMOVED
  - TREE TRUNK DIAMETER GREATER THAN 500MM

Client: HIGHWAYS DEPARTMENT WORKS DIVISION

Consultants: Mannings (Asia) Consultants Ltd in association with BMT Asia Pacific

ADI

Project Agreement No. WD 7/2007  
Upgrading of Remaining Sections of Kam Tin Road & Lam Kam Road  
Environmental Impact Assessment

Title: EXPLORATION OF ALTERNATIVE SCHEMES

Drawing No. Figure 9.15J  
Revision B

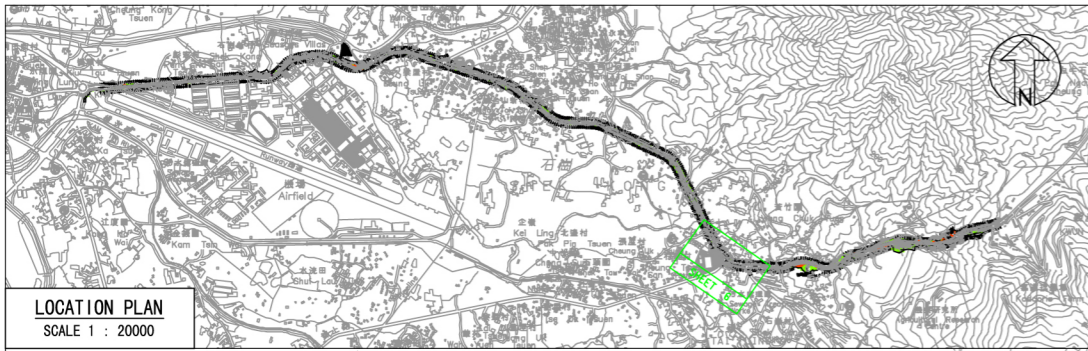

LOCATION PLAN  
SCALE 1 : 20000



OPTION A



LOCATION PLAN  
SCALE 1 : 20000



OPTION B

LEGEND:

- PRELIMINARY PROJECT BOUNDARY
- EXISTING TREE TO BE RETAINED
- EXISTING TREE TO BE TRANSPLANTED
- EXISTING TREE TO BE FELLED
- DEAD TREE TO BE REMOVED
- TREE TRUNK DIAMETER GREATER THAN 500MM

Client  
**HIGHWAYS DEPARTMENT WORKS DIVISION**

Consultants  
**Mannings (Asia) Consultants Ltd**  
*in association with*  
**BMT Asia Pacific**

ADMITTED  
LANDSCAPE ARCHITECTURE, URBAN DESIGN AND MASTER PLANNING  
10/F BANCROFT BANK BUILDING, 10 BANCROFT STREET, HONG KONG  
TEL: (852) 2119 8888 FAX: (852) 2119 8889  
www.mannings.com.hk www.bmt.com.hk

Project Agreement No. WD 7/2007  
Upgrading of Remaining Sections of Kam Tin Road & Lam Kam Road  
Environmental Impact Assessment

Title  
**EXPLORATION OF ALTERNATIVE SCHEMES**

Drawing No. Figure 9.15K  
Revision B

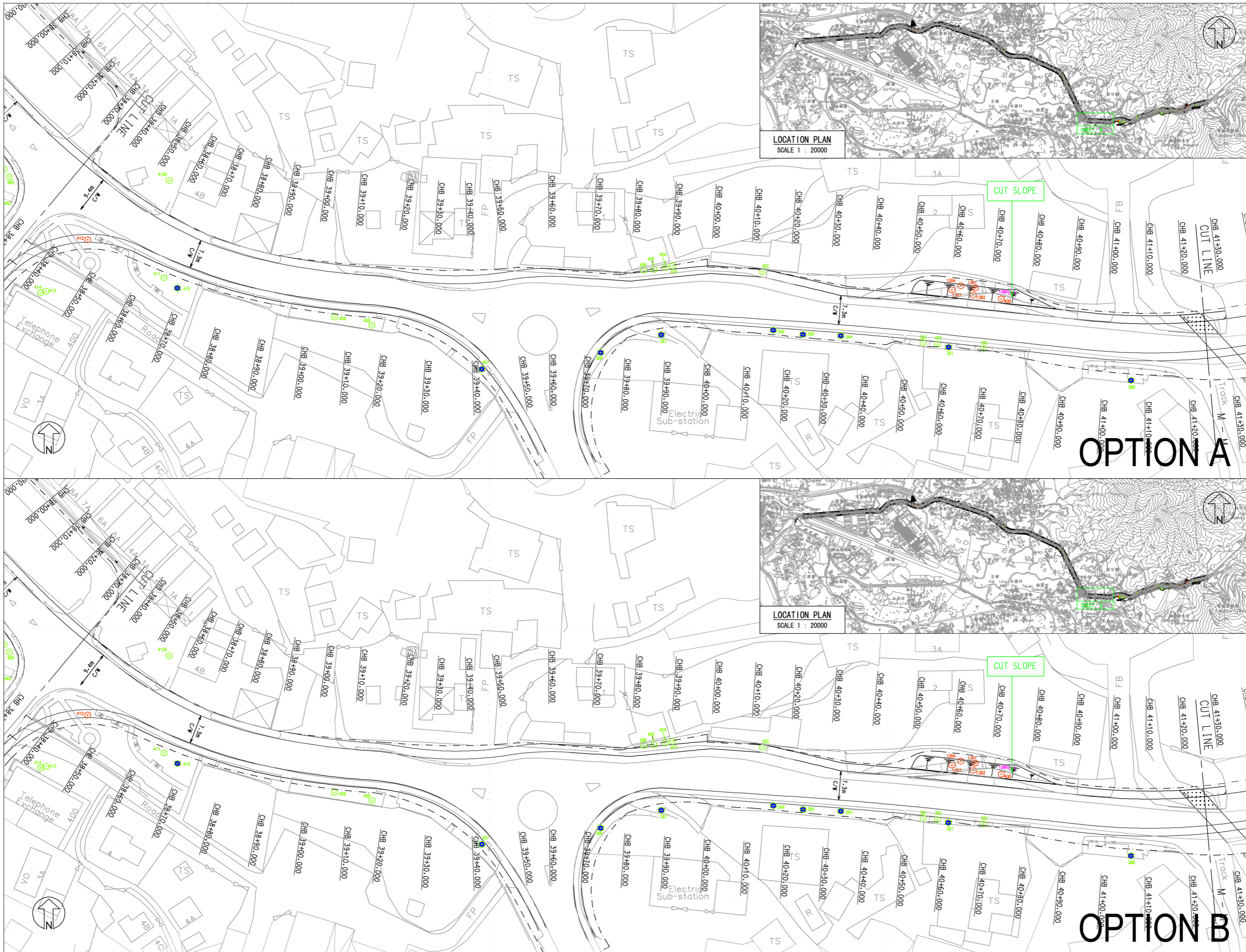

- LEGEND:**
- PRELIMINARY PROJECT BOUNDARY
  - EXISTING TREE TO BE RETAINED
  - EXISTING TREE TO BE TRANSPLANTED
  - EXISTING TREE TO BE FELLED
  - DEAD TREE TO BE REMOVED
  - TREE TRUNK DIAMETER GREATER THAN 500MM

**OPTION A**

**OPTION B**

Client  
**HIGHWAYS DEPARTMENT WORKS DIVISION**

Consultants  
**Mannings (Asia) Consultants Ltd**  
*in association with*  
**BMT Asia Pacific**

ADILIMITED  
 LANDSCAPE ARCHITECTURE, URBAN DESIGN AND MASTER PLANNING  
 10/F BANCROFT BANK BUILDING, 10 BROADWAY STRAND WEST HONGKONG  
 TEL: (852) 2500 8888 FAX: (852) 2500 8889  
 WWW.ADI.COM.HK

Project Agreement No. WD 7/2007  
 Upgrading of Remaining Sections of Kam Tin Road & Lam Kam Road  
 Environmental Impact Assessment

Title  
**EXPLORATION OF ALTERNATIVE SCHEMES**

Drawing No. **Figure 9.15L** Revision **B**

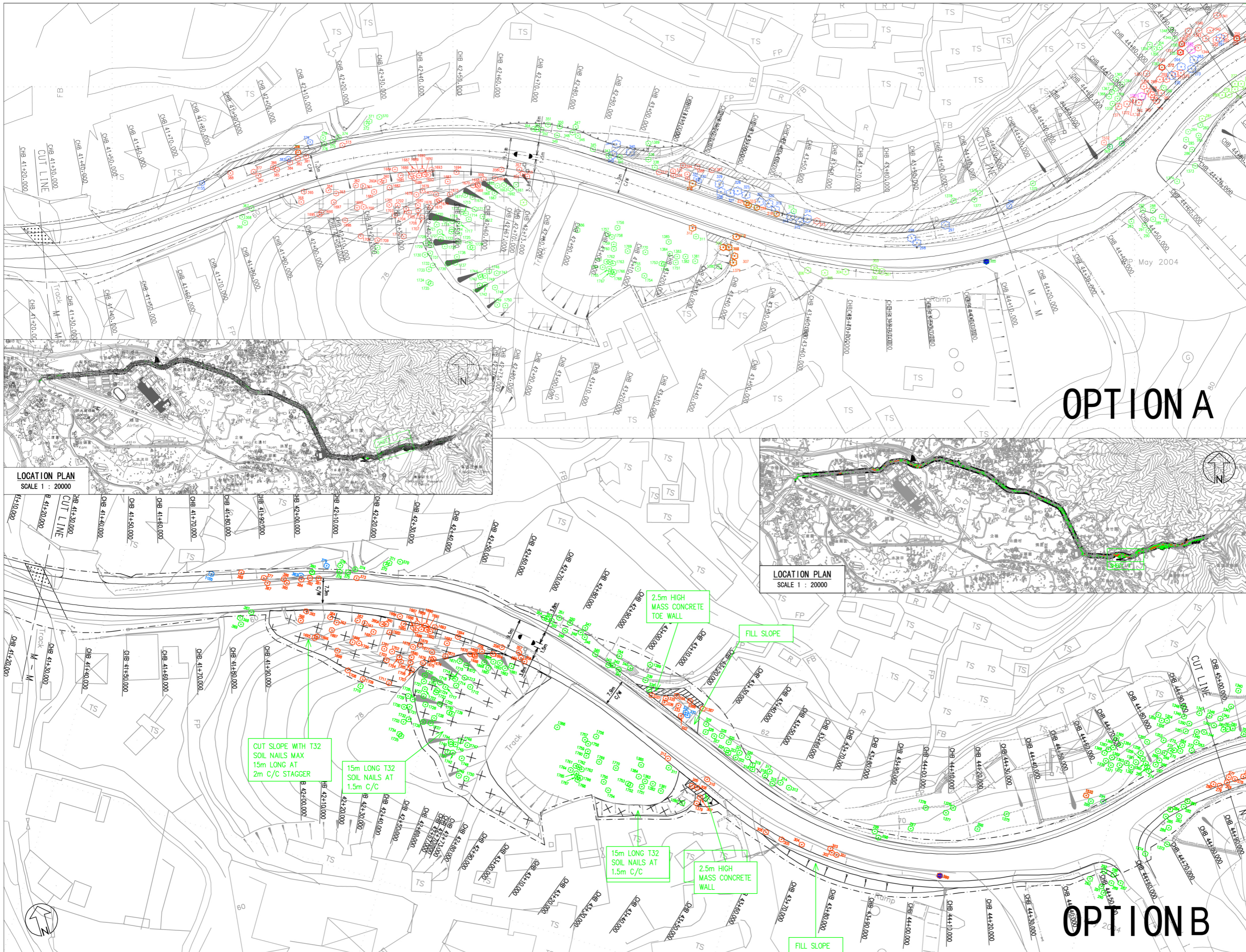

- LEGEND:**
- PRELIMINARY PROJECT BOUNDARY
  - EXISTING TREE TO BE RETAINED
  - EXISTING TREE TO BE TRANSPLANTED
  - EXISTING TREE TO BE FELLED
  - DEAD TREE TO BE REMOVED
  - TREE TRUNK DIAMETER GREATER THAN 500MM

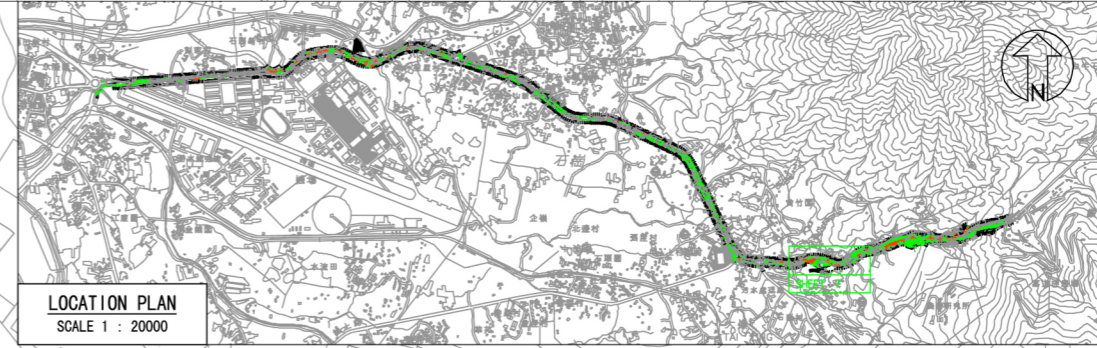
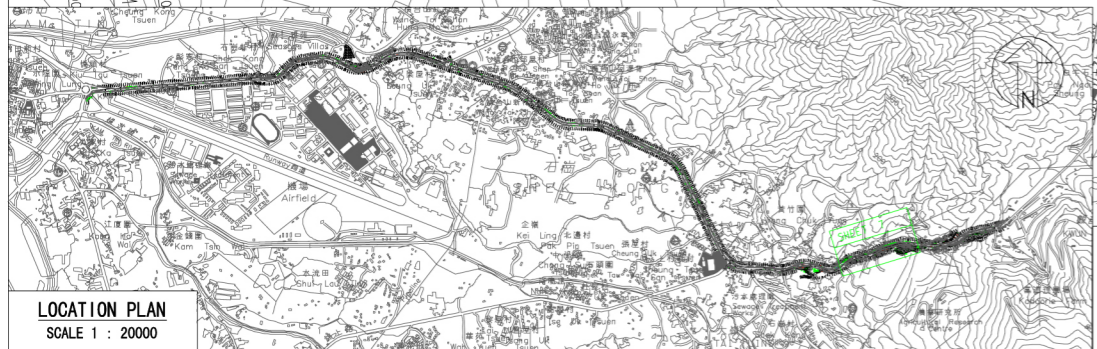

**OPTION A**

**OPTION B**

CUT SLOPE WITH T32 SOIL NAILS MAX 15m LONG AT 2m C/C STAGGER

15m LONG T32 SOIL NAILS AT 1.5m C/C

15m LONG T32 SOIL NAILS AT 1.5m C/C

2.5m HIGH MASS CONCRETE WALL

2.5m HIGH MASS CONCRETE TOE WALL

FILL SLOPE

FILL SLOPE

Client: **HIGHWAYS DEPARTMENT WORKS DIVISION**

Consultants: **Mannings (Asia) Consultants Ltd**  
in association with **BMT Asia Pacific**

**ADI**  
ADMITTED LANDSCAPE ARCHITECTURE, URBAN DESIGN AND MASTER PLANNING  
10/F BANCROFT WARE BUILDING, 10 BANCROFT STREET WEST HONG KONG  
TEL: (852) 2718 8888 FAX: (852) 2718 8888  
www.adi.com.hk

Project Agreement No. WD 7/2007  
Upgrading of Remaining Sections of Kam Tin Road & Lam Kam Road  
Environmental Impact Assessment

Title: **EXPLORATION OF ALTERNATIVE SCHEMES**

Drawing No. **Figure 9.15M** Revision **B**

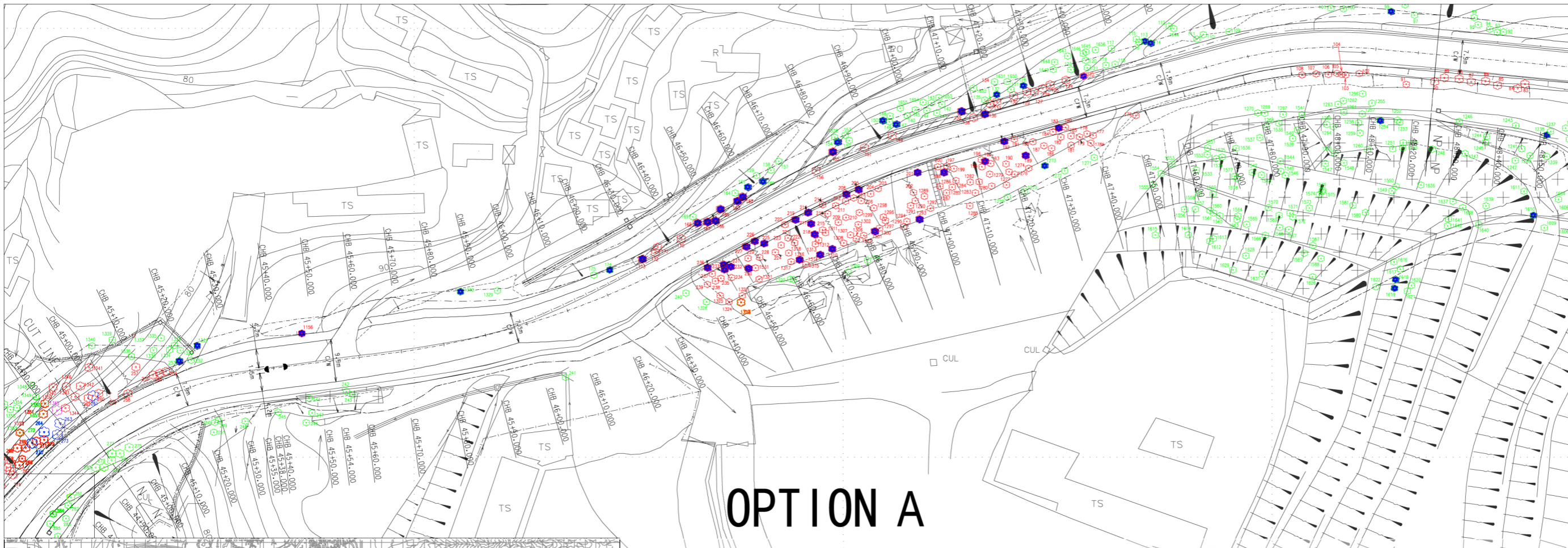

# OPTION A

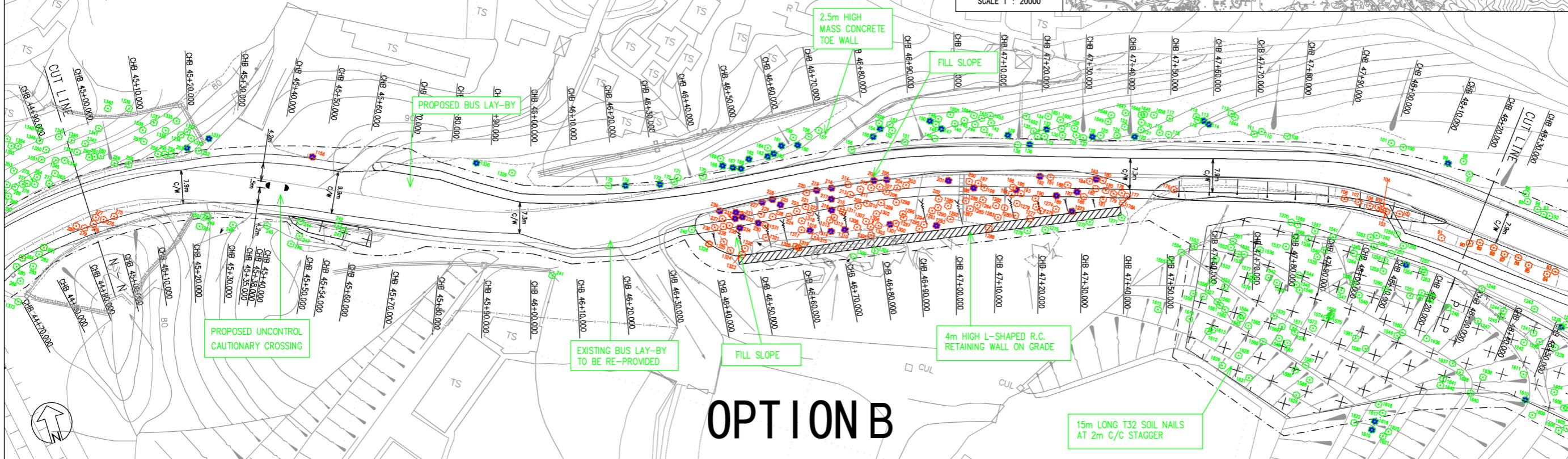
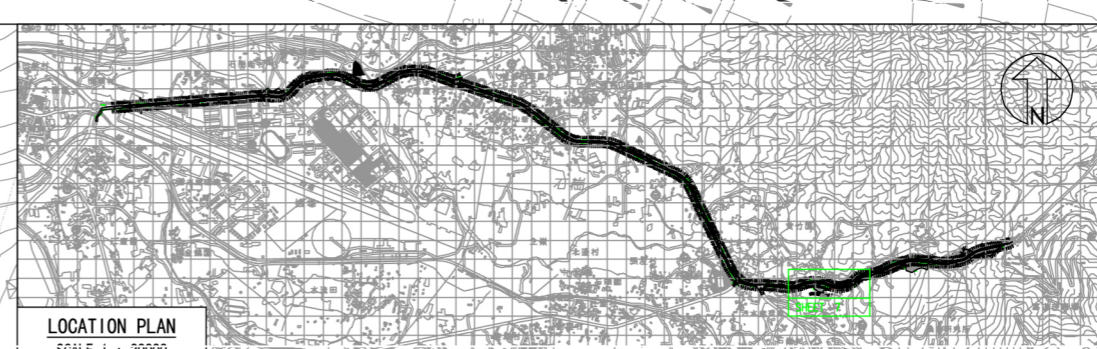
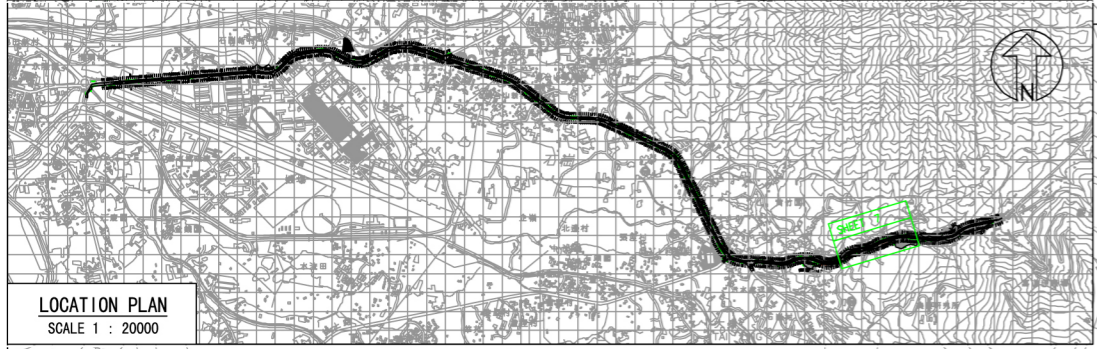

# OPTION B

- LEGEND:**
- PRELIMINARY PROJECT BOUNDARY
  - EXISTING TREE TO BE RETAINED
  - EXISTING TREE TO BE TRANSPLANTED
  - EXISTING TREE TO BE FELLED
  - DEAD TREE TO BE REMOVED
  - ★ TREE TRUNK DIAMETER GREATER THAN 500MM

Client: **HIGHWAYS DEPARTMENT WORKS DIVISION**

Consultants: **Mannings (Asia) Consultants Ltd**  
in association with **BMT Asia Pacific**

ADILIMITED  
LANDSCAPE ARCHITECTURE, URBAN DESIGN AND MASTER PLANNING  
10/F BANCROFT WARE BUILDING, 10 SCOWELL STREET WEST HONGKONG  
TEL: (852) 2100 8888 FAX: (852) 2100 8888  
www.mannings.com.hk www.bmt.com.hk

Project Agreement No. WD 7/2007  
Upgrading of Remaining Sections of Kam Tin Road & Lam Kam Road  
Environmental Impact Assessment

Title: **EXPLORATION OF ALTERNATIVE SCHEMES**

Drawing No. **Figure 9.15N** Revision **B**

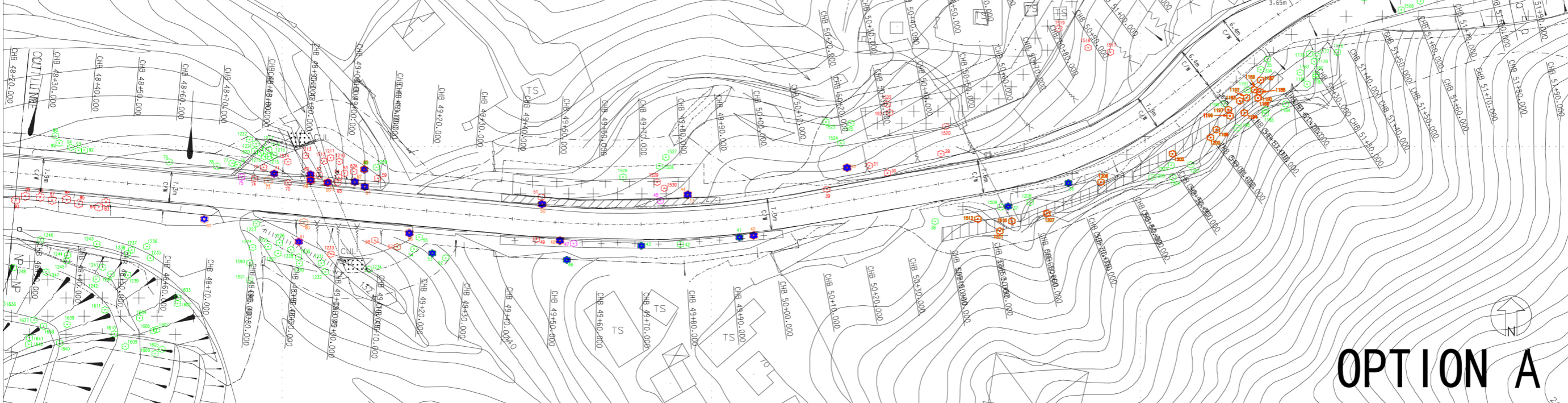
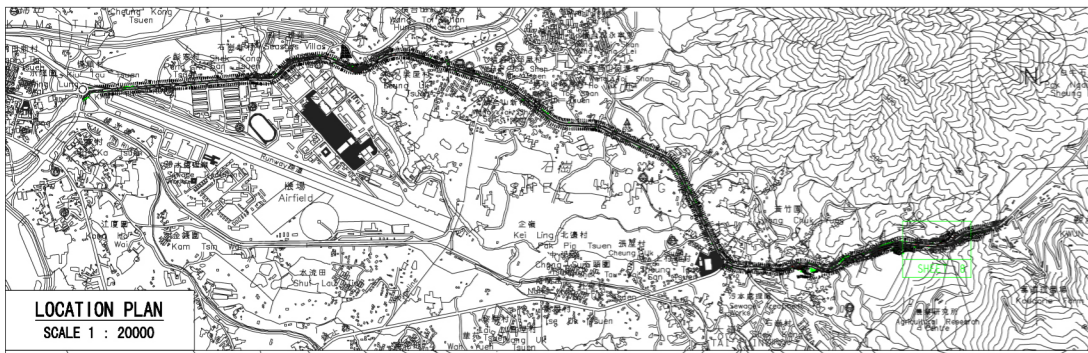

# OPTION A

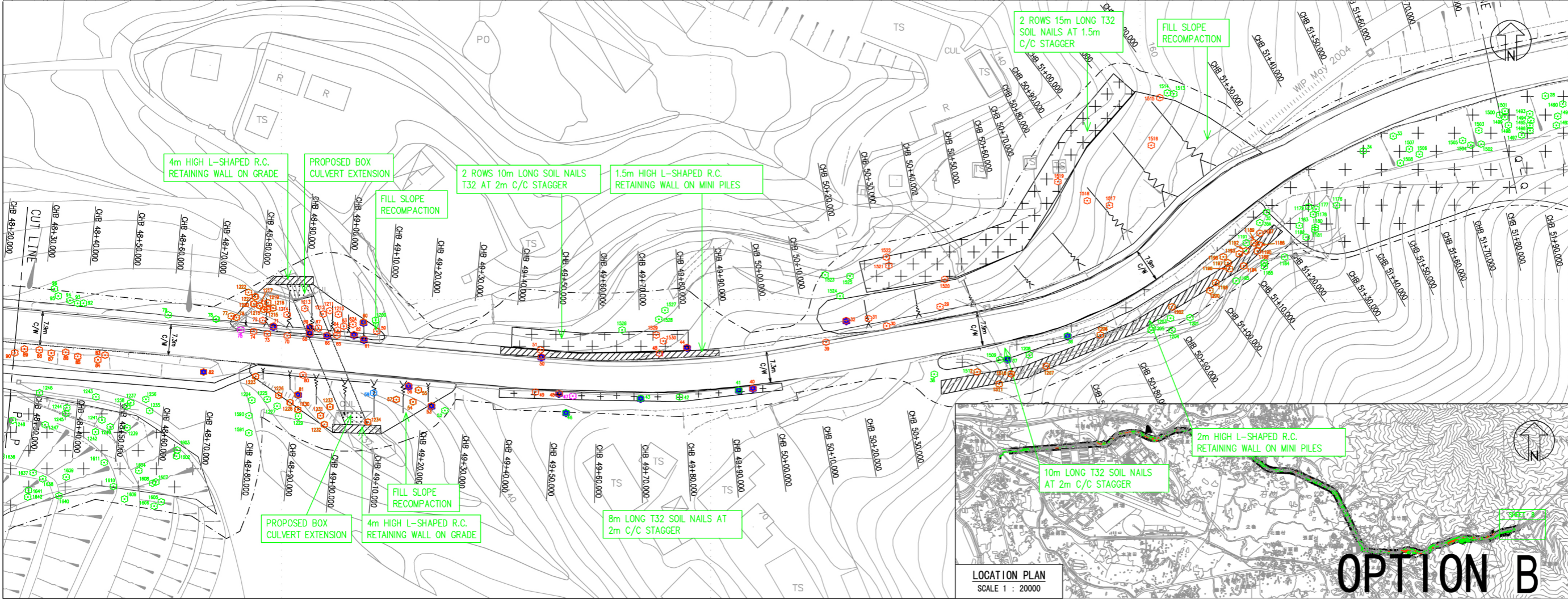

# OPTION B

- LEGEND:**
- PRELIMINARY PROJECT BOUNDARY
  - EXISTING TREE TO BE RETAINED
  - EXISTING TREE TO BE TRANSPLANTED
  - EXISTING TREE TO BE FELLED
  - DEAD TREE TO BE REMOVED
  - TREE TRUNK DIAMETER GREATER THAN 500MM

4m HIGH L-SHAPED R.C. RETAINING WALL ON GRADE  
 PROPOSED BOX CULVERT EXTENSION  
 2 ROWS 10m LONG SOIL NAILS T32 AT 2m C/C STAGGER  
 1.5m HIGH L-SHAPED R.C. RETAINING WALL ON MINI PILES  
 FILL SLOPE RECOMPACTION

2 ROWS 15m LONG T32 SOIL NAILS AT 1.5m C/C STAGGER  
 FILL SLOPE RECOMPACTION

PROPOSED BOX CULVERT EXTENSION  
 4m HIGH L-SHAPED R.C. RETAINING WALL ON GRADE  
 8m LONG T32 SOIL NAILS AT 2m C/C STAGGER

10m LONG T32 SOIL NAILS AT 2m C/C STAGGER  
 2m HIGH L-SHAPED R.C. RETAINING WALL ON MINI PILES

Client: **HIGHWAYS DEPARTMENT WORKS DIVISION**

Consultants: **Mannings (Asia) Consultants Ltd in association with BMT Asia Pacific**

ADILIMITED LANDSCAPE ARCHITECTURE, URBAN DESIGN AND MASTER PLANNING  
 10/F BANGKOK BANK BUILDING, 16 DUNDAS STREET WEST HONG KONG  
 TEL: (852) 2521 1111 FAX: (852) 2521 1112  
 香港中環德輔道中16號10樓 電話: (852) 2521 1111 傳真: (852) 2521 1112

Project Agreement No. WD 7/2007  
 Upgrading of Remaining Sections of Kam Tin Road & Lam Kam Road Environmental Impact Assessment

EXPLORATION OF ALTERNATIVE SCHEMES

Drawing No. Figure 9.150 Revision B

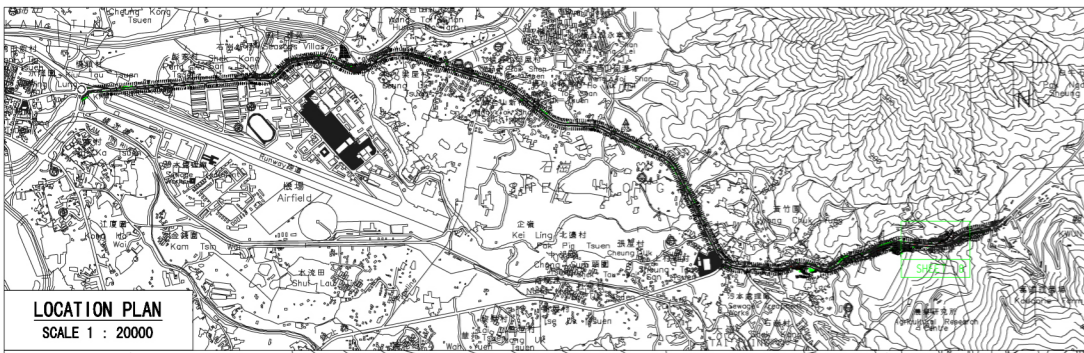

**OPTION A**

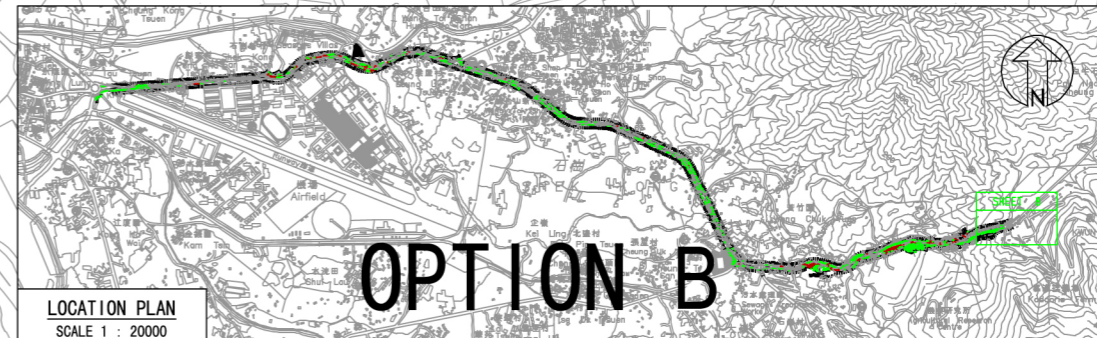
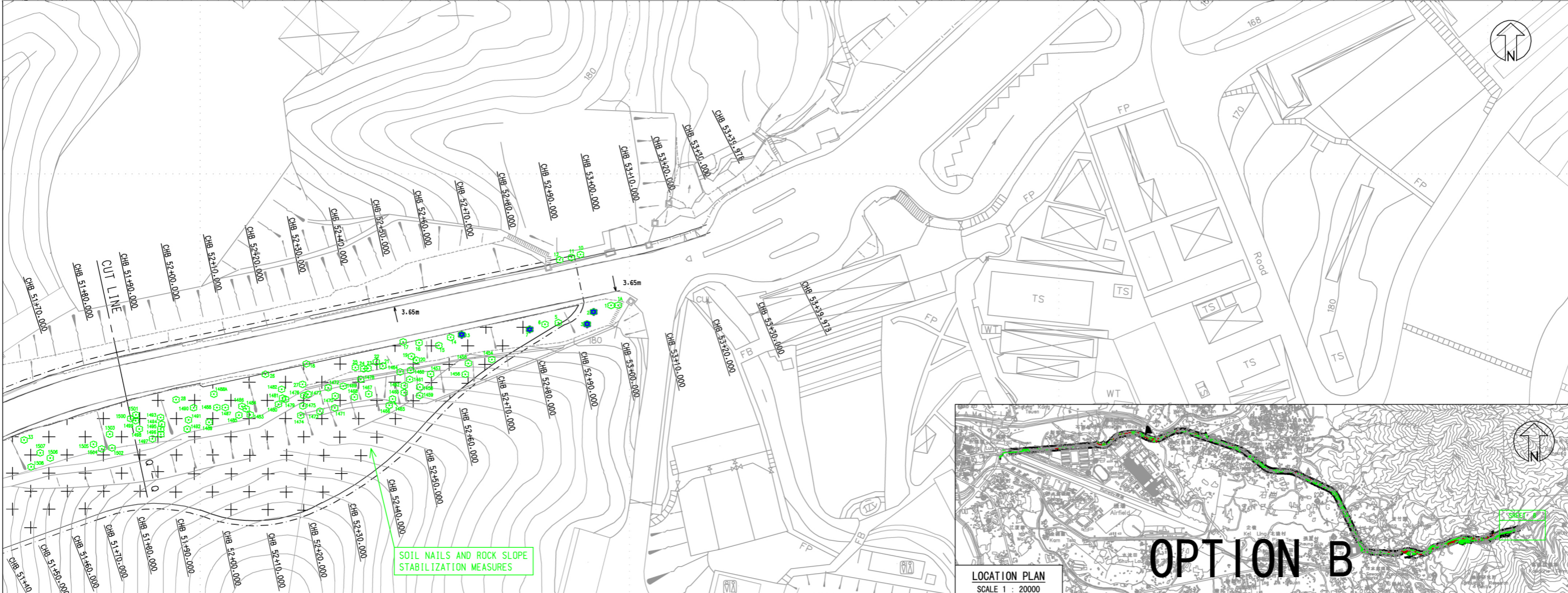

**OPTION B**

- LEGEND:**
- PRELIMINARY PROJECT BOUNDARY
  - 🌳 EXISTING TREE TO BE RETAINED
  - 🌳 EXISTING TREE TO BE TRANSPLANTED
  - 🌳 EXISTING TREE TO BE FELLED
  - 🌳 DEAD TREE TO BE REMOVED
  - 🌳 TREE TRUNK DIAMETER GREATER THAN 500MM

Client  
**HIGHWAYS DEPARTMENT WORKS DIVISION**

Consultants  
**Mannings (Asia) Consultants Ltd**  
*in association with*  
**BMT Asia Pacific**

ADILIMITED  
 LANDSCAPE ARCHITECTURE, URBAN DESIGN AND MASTER PLANNING  
 10/F BANGKOK BANK BUILDING, 16 SCOVILLE STREET, WEST HONGKONG  
 香港中環德輔道中16號10樓  
 電話: (852) 2522 1111 傳真: (852) 2522 1112

Project Agreement No. WD 7/2007  
 Upgrading of Remaining Sections of Kam Tin Road & Lam Kam Road  
 Environmental Impact Assessment

Title  
**EXPLORATION OF ALTERNATIVE SCHEMES**

Drawing No. **Figure 9.15P** Revision **B**